

TRP Standard A Type Single, Double-Sprockets are designed for use with two single strand chains. The sprockets are made of carbon steel (S35C) and hardened teeth. The maximum bore diameters shown below are based on general operating conditions using standard keys and key tapping procedure. Actual bore diameter should be determined using common machine design considerations. The fit of key and keyway should be checked on the same basis as above.

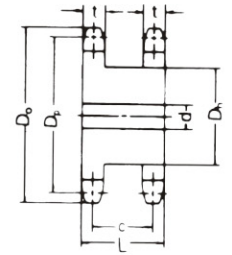
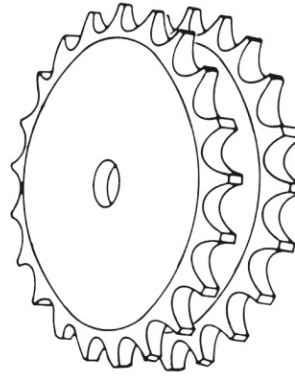

Dimension:mm									
	No of Teeth.	Outside Dia. Do	Pitch Dia. Dp	Distance Between Row C	Bore Dia. :d		Hub		Approx. WT.(kg)
					Min.	Max.	Dh Dia.	L Length.	
40SD	12	55	49.07	27.8	11	17	34	35	0.33
	13	59	53.07		14	20	38		0.40
	14	63	57.07		14	24	42		0.49
	15	67	61.08		14	25	46		0.57
	16	71	65.10		14	28	50		0.66
	17	76	69.12		14	32	54		0.76
	18	80	73.14		14	35	59		0.89
	19	84	77.16		14	37	63		1.00
	20	88	81.18		15	40	67		1.14
50SD	21	92	85.21	31.3	15	43	71	40	1.23
	12	69	61.34		15	24	43		0.63
	13	74	66.34		15	25	48		0.75
	14	79	71.34		15	30	53		0.90
	15	84	76.35		15	35	58		1.04
	16	89	81.37		15	37	63		1.22
	17	94	86.39		15	42	68		1.41
	18	100	91.42		15	44	73		1.61
	19	105	96.45		15	46	79		1.80
60SD	20	110	101.48	38.3	15	50	84	50	1.95
	21	115	106.51		15	54	89		2.27
	12	83	73.60		15	28	51		1.14
	13	89	79.60		15	35	57		1.39
	14	95	85.61		17	37	64		1.63
	15	101	91.62		17	43	70		1.93
	16	107	97.65		17	46	76		2.20
	17	113	103.67		17	50	82		2.56
	18	119	109.71		17	53	88		2.90
80SD	19	126	115.74	45.4	17	55	94	60	3.26
	20	132	121.78		17	58	100		3.70
	21	138	127.82		17	63	107		4.30
	12	110	98.14		21	42	69		2.52
	13	118	106.14		21	46	77		3.04
	14	127	114.15		21	50	85		3.60
	15	135	122.17		21	55	93		4.16
	16	143	130.20		21	58	102		4.89
	17	151	148.23		21	65	110		5.61
100SD	18	159	156.27	52.4	21	68	118	70	6.36
	19	167	164.32		22	75	126		7.13
	20	176	172.37		22	82	134		8.03
	21	184	180.42		22	90	142		8.88
	12	138	122.67		22	50	86		4.68
	13	148	132.67		22	52	96		5.10
	14	158	142.68		22	62	107		6.65
	15	168	152.71		22	68	117		7.83
	16	179	162.74		22	75	127		9.00
100SD	17	189	172.79	52.4	22	85	127	70	10.30
	18	199	182.84		22	95	148		11.80
	19	209	192.90		26	100	158		13.20
	20	220	202.96		26	110	168		14.70
	21	230	213.03		26	120	170		16.40

NOTE: 1. Tooth thickness: Refer to A type simple sprocket.
 2. Sprockets which are not listed in the above are also available.
 3. Bores, keyways and set screws can be machined upon request.