

A TYPE

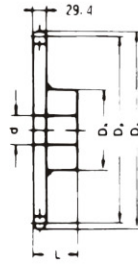

BW TYPE



CW TYPE

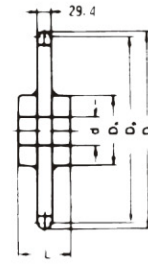

Dimension:mm

No. of Teeth	Pitch Dia. Dp	Outside Dia. Do	A Type			B Type / BW Type					Duplex B Type / Duplex BW Type								
			Bore: d	Approx. WT.(kg)	Material	Bore:d		Hub		Approx. WT.(kg)	Material	Bore:d		Hub		Approx. WT.(kg)	Material		
						Min.	Max.	Dh	L			Min.	Max.	Dh	L				
10	164.39	185.0	25	4.80	SS41	25	70	105	63	6.80	SS41 (BW TYPE)								
11	180.31	200.8	25	5.79		25	80	117	63	8.30									
12	196.28	216.8	25	6.86		25	89	127	63	9.90									
13	212.27	232.8	25	8.03		25	95	137	71	12.50									
14	228.30	248.8	25	9.28		25	95	137	71	13.80									
15	244.33	264.8	30	10.63		30	95	137	71	15.20									
16	260.39	280.9	30	12.08		30	103	147	71	17.40									
17	276.46	296.9	30	13.61		30	103	147	71	18.90									
18	292.55	313.0	30	15.23		30	103	147	71	20.60									
19	308.64	329.1	30	16.95		30	103	147	71	22.30									
20	324.74	345.2	30	18.75		30	103	147	71	24.20									
21	340.84	361.3	30	20.65		30	103	147	71	26.10									
22	356.96	377.5	35	22.64		35	118	167	80	30.20		35	105	157	120				
23	373.07	393.6	35	25.10		35	118	167	80	32.20		35	105	157	120				
24	389.19	409.7	35	26.90		35	118	167	80	34.40		35	105	157	120				
25	405.32	425.8	35	29.16		35	118	167	80	36.60		35	105	157	120				
26	421.45	441.9	35	31.52		35	118	167	80	38.40		35	105	157	120				
27	437.58	458.1	35	34.20		35	118	167	80	46.28		35	105	157	120				
28	453.72	474.2	35	36.51		35	118	167	80			35	105	157	120				
29	469.85	490.4	35			35	118	167	80			35	105	157	120				
30	485.99	506.5	35	41.86		35	118	167	100	52.30		35	105	157	120				
31	502.13	522.7	35			35	118	167	100			35	105	157	120				
32	518.28	538.8	35	47.95		35	118	167	100	62.00		35	105	157	120				
35	566.71	587.2	35	57.24		35	118	167	100	66.90		35	105	157	130				
36	582.86	603.3	35	60.53		35	118	167	100			35	110	157	130				
38	615.17	635.5	35	67.37		35	118	167	100			35	110	157	130				
40	647.47	670.3	35	74.57		35	118	167	110	85.80		35	110	167	140				
42	679.78	702.6	35	82.14		35	118	167	110			35	110	167	140				
45	728.25	751.0	35	94.71		35	132	187	125	92.40		35	110	167	140				
48	776.72	799.5	35	107.61		35	132	187	125			35	110	167	140				
50	809.04	831.8	35	116.67	35	132	187	125		35	110	167	140						
54	873.68	896.5	35	135.88	35	132	187	125	100.90	35	110	167	140						
57	922.16	945.0	35		35	132	187	125		35	110	167	140						
60	970.65	993.4	35	168.14	35	132	187	125	135.40	35	110	167	140						

NoTE: 1. B-type solid sprockets made by S35C are available.