

BW TYPE

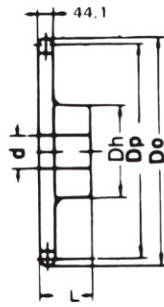

CW TYPE

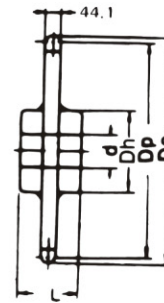

Dimension:mm

No. of Teeth	Pitch Dia. Dp	Outside Dia. Do	B Type / BW Type					Duplex B Type / Duplex BW Type						
			Bore:d		Hub		Approx. WT.(kg)	Material	Bore:d		Hub		Approx. WT.(kg)	Material
			Min.	Max.	Dh	L			Min.	Max.	Dh	L		
11	270.47	305	68	110	177	100	27.9							
12	294.41	330	68	120	187	100	32.9							
13	318.41	355	68	120	187	100	36.9							
14	342.44	380	68	120	187	100	41.1							
15	366.50	404	68	120	187	100	45.7							
16	390.59	429							68	125	197	105	54.7	
17	414.70	453							68	125	197	105	60.0	
18	438.82	478							68	125	197	105	66.7	
19	462.95	502							68	125	197	105	71.3	
20	487.11	527							68	125	197	105	77.5	
21	511.26	551							68	125	197	105	83.9	
22	535.43	576							68	125	197	105	90.7	
23	559.61	600							68	125	197	105	98.4	
24	583.79	625							68	125	197	105	106.0	
25	607.98	649							68	125	197	105	114.0	
30	728.99	771							83	145	227	160	175.0	
35	850.07	892							83	145	227	160	228.0	
40	971.21	1014							88	155	247	170	295.0	
45	1092.37	1135							88	155	247	170	362.0	
50	1213.56	1257							88	155	247	170	440.0	

NOTE:1.B-type&C-type solid sprockets made by S335C are available.