

BW TYPE

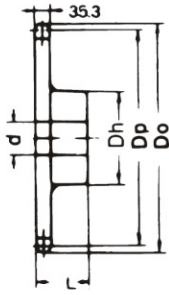

CW TYPE

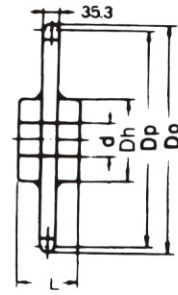

Dimension:mm

N o. Of Teeth	Pitch Dia. Dp	Outside Dia. Do	B Type / BW Type					CW Type						
			Bore:d		Hub		Approx. WT.(kg)	Material	Bore:d		Hub		Approx. WT.(kg)	Material
			Min.	Max.	Dh	L			Min.	Max.	Dh	L		
11	225.39	254	53	90	147	100	28.6							
12	245.34	275	58	100	163	110	32.6							
13	265.34	296	63	110	182	120	33.1							
14	285.37	316	63	110	182	120	35.4							
15	305.42	337	63	110	182	120	37.9							
16	325.49	357	68	120	197	130	43.5							
17	345.58	378	68	120	197	130	46.3							
18	365.68	398												
19	358.79	419						68	120	197	130	49.2		
20	405.92	439						68	120	197	130	52.3		
21	426.05	459						78	130	212	140	60.6		
22	446.20	480						78	130	212	140	68.6		
23	466.34	500						78	130	212	140	71.9		
24	486.49	520						78	130	212	140	75.6		
25	506.65	541						78	130	212	140	79.6		
28	526.81	561						83	140	227	150	80.4		
28	567.14	602						83	140	227	150	84.7		
30	607.49	642						83	140	227	150	93.7		
32	647.85	683						83	140	227	150	103.0		
35	708.39	744						88	150	247	160	115.0		
40	809.34	845						88	150	247	160	117.0		
45	910.31	946						88	150	247	160	138.0		
48	970.90	1007						98	170	277	180	181.0		
50	1011.30	1047						98	170	277	180	193.0		
55	1112.30	1149						98	170	277	180	203.0		
60	1213.31	1250						98	170	277	180	252.0		
								98	170	277	180	262.0		

NOTE: 1.B-type & C-type solid sprocket made by S35C are available